

# Blast chiller tunnel Metos

## MBC201SB-RT

General features and functions of the Blast Chiller room Metos BC201SB- RT for trolleys

- capacity 20 x GN 1/1-40 or GN 10 x GN 1/1-65
- suitable for one GN 1/1 -trolley
- blast chilling
- two doors, roll through model
- inner measurements (length x depth x height) 680 x 950 x 1820 mm
- stainless steel construction
- floorless
- insulation made of high density polyurethane foam, thickness 80 mm
- copper-aluminum evaporator with cathodolysis anti-corrosion treatment
- high-ventilation evaporator to ensure the highest efficiency of the cooling system
- hinged door with gasket and closing ramp system
- vertical ergonomic door handle with magnetic closure
- rounded inner corners helps the cleaning
- inner bumpers in stainless steel
- fully inspectable front electric panel and IP54
- 7" high-definition IPS capacitive TOUCH display, easy to use
- high-performance evaporator fans - possibility to adjust the air flow in the blast chiller during chilling process
- USB port for HACCP data download, recipes and software update
- multipoint probe ensures an accurate chilling process by measuring the food core and surface temperatures
- possibility to program and save several customized chilling programs
- pre-cooling button ensures static blast chilling of food as soon as it is placed in the appliance
- after chilling process the machine automatically continues on the conservation phase
- chilling capacity 110 kg; stated blast chilling capacity kg/h is nominal, and cannot



be achieved with all food products and circumstances

- for remote cooling, the cooling unit is not included in the delivery

- circuit breaker for compressor protection

- Class T (ambient temperature + 43 ° C) be achieved with all food products and circumstances

- for remote cooling, the cooling unit is not included in the delivery

- circuit breaker for compressor protection

- Class T (ambient temperature + 43 ° C)

## Blast chiller tunnel Metos MBC201SB-RT

Product capacity	150kg/+70...+3°C
Item width mm	1300
Item depth mm	1400
Item height mm	2040
Package volume	5.766
Unit of volume	m3
Package volume	5.766 m3
Package length	240
Package width	156
Package height	154
Package unit of dimension	cm
Package dimensions (LxWxH)	240x156x154 cm
Net weight	446
Net weight	446 kg
Gross weight	610
Package weight	610 kg
Unit of weight	kg
Connection power kW	6.288
Fuse Size A	10
Connection voltage V	400
Number of phases	3NPE
Frequency Hz	50
Protection rating (IP)	54
Type of electrical connection	Semifixed
Cooling capacity W	5630
Condensing temperature °C	+45
Evaporation temperature °C	-25
Type of the refrigerant	R452A/R448A/R449A
Remarks (refrigeration)	Remote cooling

**Blast chiller tunnel Metos MBC201SB-RT**

Cooling unit	Remote cooled
--------------	---------------

**metos**

## BC201SB-RT

- ① INGRESSO REFRIGERANTE  
REFRIGERANT INLET
- ② USCITA REFRIGERANTE  
REFRIGERANT OUTLET
- E CONNESSIONE ELETTRICA  
ELECTRICAL CONNECTION
- W CONNESSIONE SCARICO  
DRAIN CONNECTION
- DIMENSIONI mm  
DIMENSIONS [in]

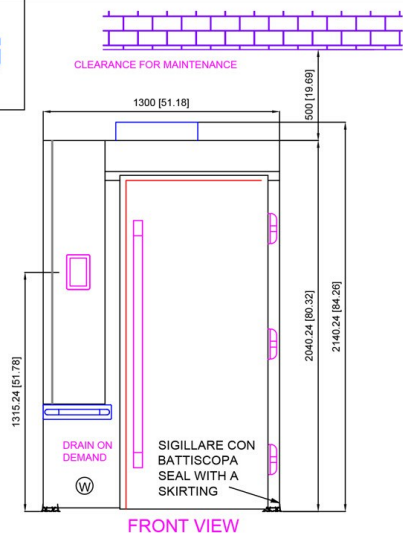

FRONT VIEW

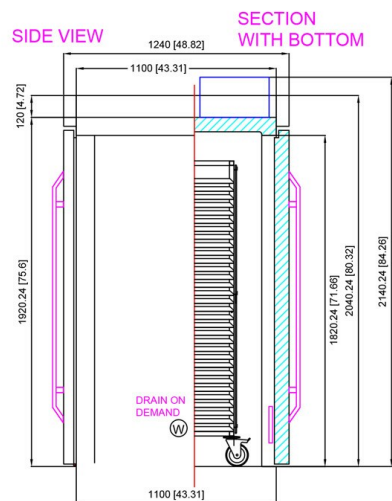

SIDE VIEW

SECTION WITH BOTTOM

TOP VIEW

201 SECTION

